

This is a PROFESSIONAL BUILDING PLAN approved only for the purpose of filing objections from the general public.

**Harpreet Kaur**  
 Architect  
 Harpreet Kaur Architects  
 1100 Avenue Road, Suite 100  
 Toronto, Ontario M5E 1B5  
 Tel: 416-461-1100  
 Fax: 416-461-1101  
 Email: info@hkarchitects.com

**Rama Arora**  
 Architect  
 Rama Arora Architects  
 1100 Avenue Road, Suite 100  
 Toronto, Ontario M5E 1B5  
 Tel: 416-461-1100  
 Fax: 416-461-1101  
 Email: info@raaarchitects.com

**Harpreet Kaur**  
 Architect  
 Harpreet Kaur Architects  
 1100 Avenue Road, Suite 100  
 Toronto, Ontario M5E 1B5  
 Tel: 416-461-1100  
 Fax: 416-461-1101  
 Email: info@hkarchitects.com

**Rama Arora**  
 Architect  
 Rama Arora Architects  
 1100 Avenue Road, Suite 100  
 Toronto, Ontario M5E 1B5  
 Tel: 416-461-1100  
 Fax: 416-461-1101  
 Email: info@raaarchitects.com

**Note:-**

- BUILDING HAS AUTOMATIC SPRINKLER SYSTEM AS REQUIRED BY NBC.
- BUILDING WILL BE DESIGNED (STRUCTURES) AS PER RELEVANT IS CODES FOR EARTH QUAKE RESISTANCE.
- BUILDING IS ARTIFICIALLY LIGHTED MECHANICALLY VENTILATED & CENTRALLY AIRCONDITIONED WITH 100% FRESH AIR SUPPLY.

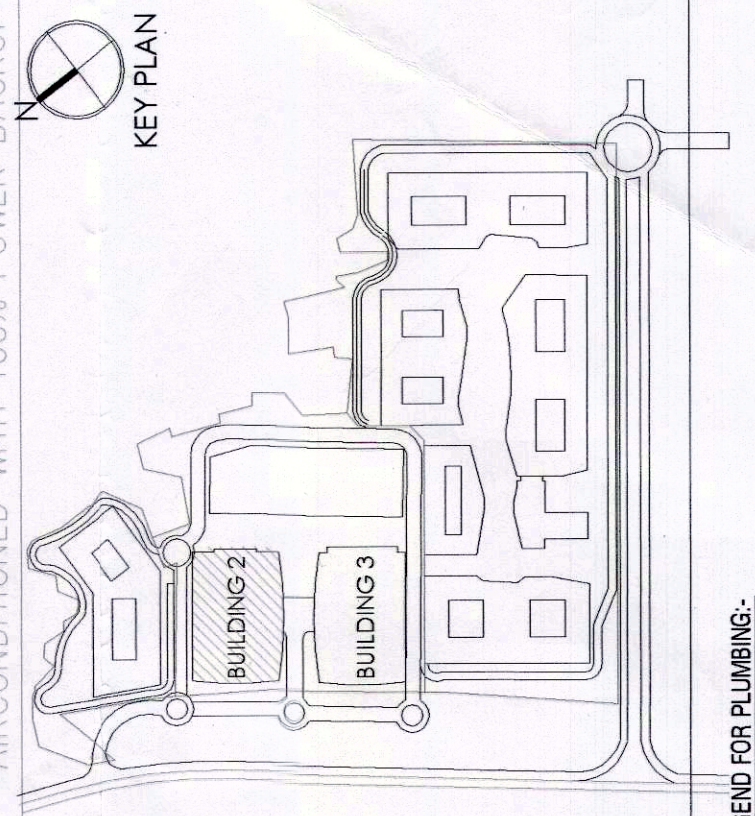

**LEGEND FOR BUILDINGS:**

S.NO.	SYMBOL	DESCRIPTION
01.	①	110 OD SOLI PIPE
02.	②	110 OD WASTE PIPE
03.	③	75 OD ANTISPONGE PIPE
04.	④	DOMESTIC WATER SUPPLY HYDRO-PNEUMATIC
05.	⑤	DOMESTIC WATER SUPPLY HYDRO-PNEUMATIC
06.	⑥	FLUSHING WATER SUPPLY HYDRO-PNEUMATIC
07.	⑦	160 OD TERRACE RAIN WATER PIPE
08.	⑧	110 OD MURPHY/BALCONY RAIN WATER PIPE
09.	⑨	FLOOR DRAIN
10.	⑩	FLOOR TRAP
11.	⑪	URINAL TRAP
12.	⑫	CLEAN OUT PLUG
13.	⑬	SOIL PIPE
14.	⑭	WASTE PIPE
15.	⑮	VENT PIPE
16.	⑯	RAIN WATER PIPE
17.	⑰	DOMESTIC WATER PIPE
18.	⑱	FLUSHING WATER PIPE

**Architects:**  
**Arcop Associates Pvt. Ltd.**  
 Plot- 36B, Sec-32, Gurgaon-12001  
 Ph: +91-124-4995500 FAX: +91-124-4995550  
 Montreal, Toronto, New-Delhi, Boston

**PROJECT:**  
 PROPOSED REVISED BUILDING PLAN OF COMMERCIAL COLONY AREA MEASURING 32.36 ACRES PART OF RESIDENTIAL PLOTTED COLONY NAMED DLF CITY PHASE III (B) AND INDEPENDENT COMMERCIAL COLONY 4.00 ACRES (LICENCE NO. 59 OF 2018 DATED 07.09.2018) BY MAKING TOTAL AREA MEASURING 36.36 ACRES UNDER T0D ZONE IN SECTOR-24 & 25A GURGRAM MANESAR URBAN COMPLEX DEVELOPED BY DLF LIMITED AND OTHERS.

**DRAWING TITLE:**  
 TYPICAL FLOOR, F.A.R.  
 BUILDING-4

**JOB NO.:** DTN/B4/09

**SCALE:** 1:200

**DATE:** 25-05-2021

**APPROVED BY:** VIKRAM

**ARCHITECTS, SEAL & SIGNATURE:** VIKRAM'S SEAL & SIGNATURE

**DATE:** 25-05-2021

**APPROVED BY:** VIKRAM

**ARCHITECTS, SEAL & SIGNATURE:** VIKRAM'S SEAL & SIGNATURE

**DATE:** 25-05-2021

**APPROVED BY:** VIKRAM

**ARCHITECTS, SEAL & SIGNATURE:** VIKRAM'S SEAL & SIGNATURE

**DOOR WINDOW SCHEDULE**

S.NO.	LEGEND	WIDTH (mm)	HEIGHT (mm)	CULT. HT. LEVEL	REMARKS	LOCATION	FIRE RATING
1	D1	800	2100	0	2115	WOODEN DOOR	2
2	D2	900	2000	0	2115	WOODEN DOOR	2
3	D3	1050	2100	0	2115	WOODEN DOOR	2
4	D3a	1050	2400	0	2415	WOODEN DOOR	2
5	D3b	1050	2100	0	2115	WOODEN DOOR	2
6	D3c	1050	2100	0	2115	WOODEN DOOR	2
7	D4	1200	2400	0	2415	WOODEN DOOR	2
8	D5	1600	2400	0	2415	WOODEN DOOR	2
9	D6	2000	2400	0	2415	WOODEN DOOR	2
10	D7	1350	2400	0	2415	WOODEN DOOR	2
11	D7a	1350	2400	0	2415	WOODEN DOOR	2
12	D8	2000	2400	0	2415	WOODEN DOOR	2
13	D10	3000	2400	0	2415	WOODEN DOOR	2
14	D11	1050	2400	0	2415	WOODEN DOOR	2
15	FC2	900	2000	0	2115	WOODEN DOOR	2
16	FC3	900	2000	0	2115	WOODEN DOOR	2
17	FC4	900	2000	0	2115	WOODEN DOOR	2
18	FC5	900	2000	0	2115	WOODEN DOOR	2
19	FD1	2000	2400	0	2415	METAL FIRE DOOR	2
20	FD2	1600	2400	0	2415	METAL FIRE DOOR	2
21	FD2b	1600	2100	0	2115	METAL FIRE DOOR	2
22	FD2c	1600	2400	0	2415	METAL FIRE DOOR	2
23	FD2d	1200	2100	0	2115	METAL FIRE DOOR	2
24	FD3	900	2100	0	2115	METAL FIRE DOOR	2
25	FD4	1200	2400	0	2415	METAL FIRE DOOR	2
26	FD5	1200	2100	0	2115	METAL FIRE DOOR	2
27	FD6	1200	2100	0	2115	METAL FIRE DOOR	2
28	FD6b	1200	2100	0	2115	METAL FIRE DOOR	2
29	FD9	2000	2700	0	2915	METAL FIRE DOOR	2
30	FD11	1000	2100	0	2115	METAL FIRE DOOR	2
31	FD13	2000	2600	0	2915	METAL FIRE DOOR	2
32	FD15	900	2100	0	2215	METAL FIRE DOOR	2
33	FD19	1000	2100	0	2215	METAL FIRE DOOR	2

**ADDITION AREA**

T.NO.	TYPE	Length	Breadth	Area (sq.ft)	Total Area
A	SEGMENT	2.89	0.37	0.7951	2.89724
B	SEGMENT	2.89	0.37	0.7951	2.89724
C	SEGMENT	39.91	1.18	46.1146	86.26292
D	SEGMENT	39.91	1.73	69.0443	155.30726
E	SEGMENT	144.25	10.76	1540.537	2693.0942
F	RECTANGLE	43.84	1.0628	46.57483	3139.4815
<b>TOTAL ADDITION AREA IN SQ.M</b>					<b>3443.9844</b>

**SUBTRACTOR AREA**

T.NO.	TYPE	Length	Breadth	Area (sq.ft)	Total Area
24	RECTANGLE	4	1.03	4.12	6.386
25	RECTANGLE	8	0.6	4.8	11.186
26	RECTANGLE	8	0.6	4.8	15.986
27	RECTANGLE	3	0.5	1.5	17.486
28	RECTANGLE	1	1.1	1.21	18.696
29	RECTANGLE	1	0.8	0.64	19.336
30	RECTANGLE	1	0.8	0.64	20.176
31	RECTANGLE	3	1.1	3.3	23.476
32	RECTANGLE	2	1.45	2.1025	24.9285
33	RECTANGLE	2	1.45	2.1025	26.431
34	RECTANGLE	4	1.1	4.84	27.591
35	RECTANGLE	4	1.1	4.84	28.751
36	RECTANGLE	4	1.1	4.84	29.911
37	RECTANGLE	2	0.95	1.8025	30.7635
38	RECTANGLE	4	0.95	3.8025	31.616
39	RECTANGLE	4	0.95	3.8025	32.4685
40	RECTANGLE	4	0.95	3.8025	33.321
41	RECTANGLE	4	0.95	3.8025	34.1735
42	RECTANGLE	3	0.95	2.8575	35.026
43	RECTANGLE	4	2.4	5.76	35.8785
44	RECTANGLE	4	0.95	3.8025	36.731
45	RECTANGLE	2	2.45	6.0025	37.5835
46	RECTANGLE	2	2.45	6.0025	38.436
47	RECTANGLE	1	0.95	0.9025	39.2885
48	RECTANGLE	8	0.95	7.6025	40.141
49	RECTANGLE	8	2.3	5.29	41.431
50	RECTANGLE	4	0.95	3.8025	42.7215
51	RECTANGLE	4	0.95	3.8025	44.012
52	RECTANGLE	1	0.4	0.16	44.412
53	RECTANGLE	4	2.4	5.76	46.172
54	RECTANGLE	4	3.7	13.69	59.862
55	RECTANGLE	2	3.1	9.61	69.472
56	RECTANGLE	2	3.1	9.61	79.082
57	RECTANGLE	2	1.4	1.96	80.582
58	RECTANGLE	2	1.45	2.1025	82.7845
59	RECTANGLE	2	1.45	2.1025	85.187
60	RECTANGLE	2	1.1	1.21	86.397
61	RECTANGLE	2	1.1	1.21	87.607
62	RECTANGLE	4	1.3	1.69	89.297
63	RECTANGLE	2	1.2	1.44	90.757
64	RECTANGLE	2	0.95	0.9025	91.6595
65	RECTANGLE	4	1.2	1.44	93.0995
66	RECTANGLE	4	1.2	1.44	94.5395
67	RECTANGLE	7	5.1	26.01	120.5495
68	RECTANGLE	4	3.63	13.1769	133.7264
69	RECTANGLE	4	3.63	13.1769	147.9033
70	TRIANGLE	4	0.3	0.18	148.0833
71	TRIANGLE	4	0.3	0.18	148.2633
72	RECTANGLE	2	0.7	0.49	148.7533
73	RECTANGLE	2	0.7	0.49	149.2433
74	RECTANGLE	4	0.95	0.9025	150.1958
75	RECTANGLE	2	0.65	0.4225	150.8483
76	RECTANGLE	2	1.15	1.3225	152.2708
77	RECTANGLE	2	1.15	1.3225	153.6933
78	RECTANGLE	1	1.85	3.4225	157.1158
<b>TOTAL SUBTRACTOR AREA IN SQ.M</b>					<b>1078.011</b>

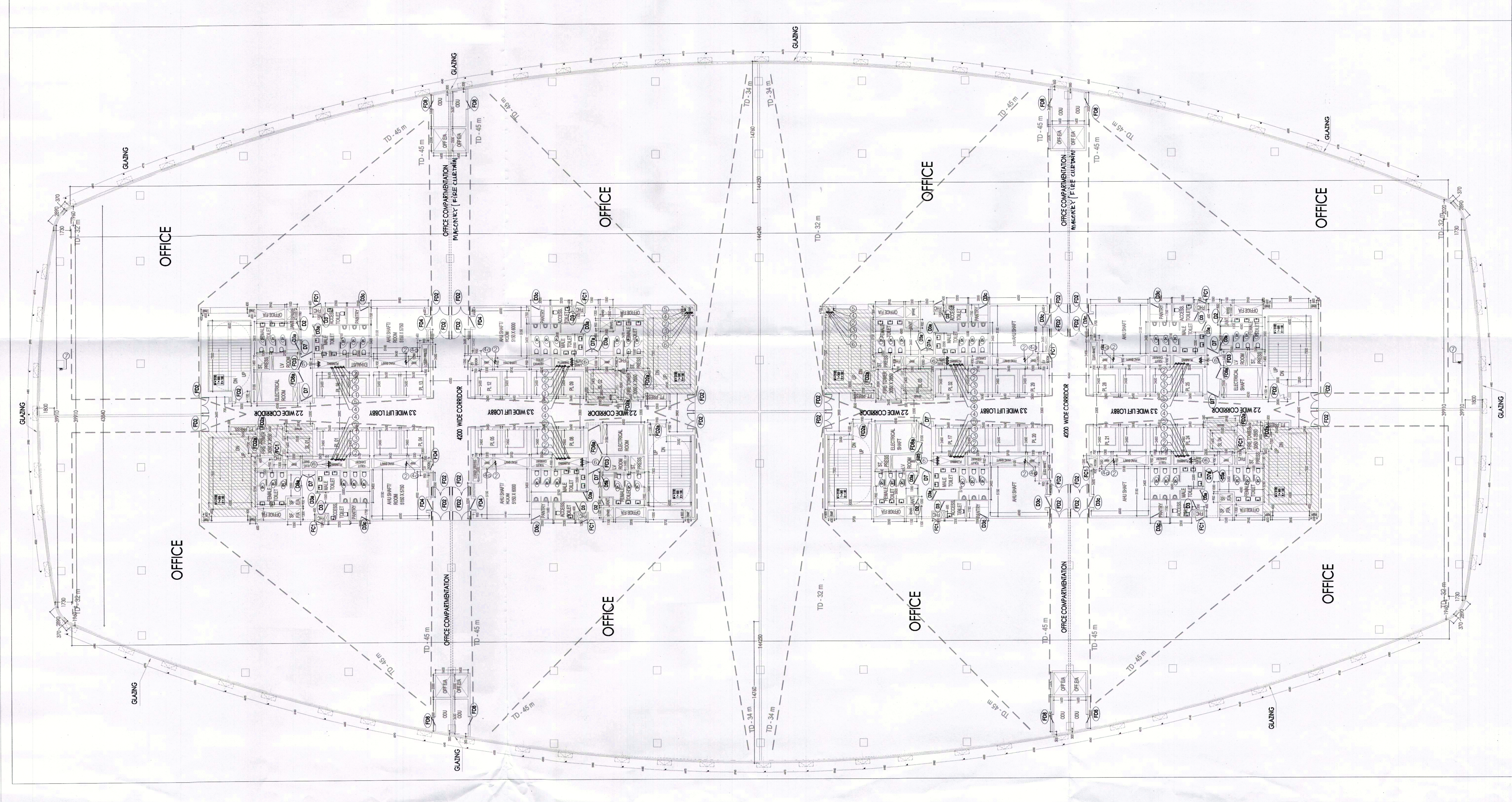
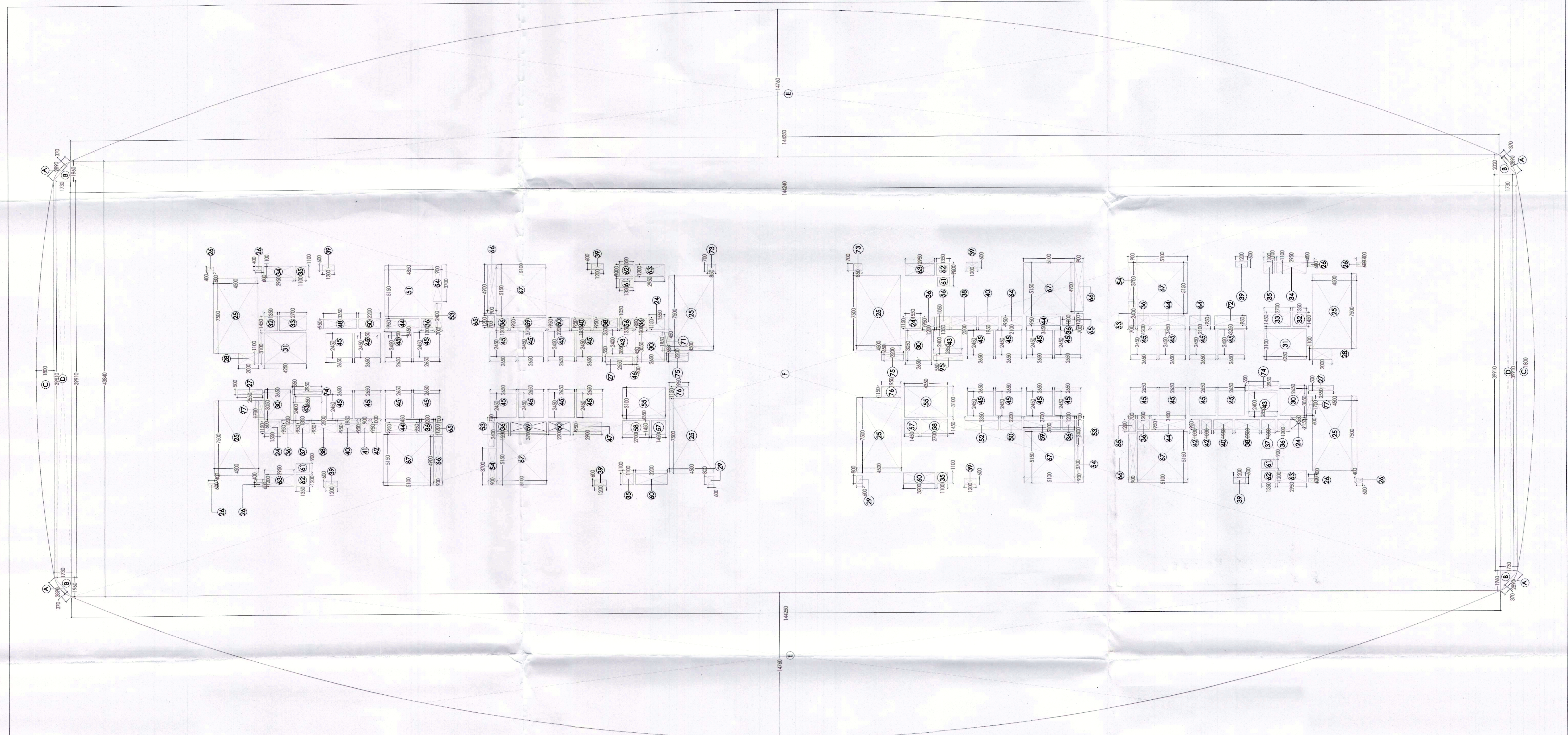

AREA DIAGRAM OF TYPICAL FLOOR PLAN

TYPICAL FLOOR PLAN-BUILDING 4

3rd to 5th and 7th to 8th  
 1:200  
 Note: Operable windows are provided @ c/c distance less than 10 meters.  
 Containmentment shall be through physical wall 12hr rated fire curtain.

**NOTES:-**

- ALL PIPE DIAMETERS ARE IN MM
- ALL CONNECTIONS FLOOR DRAIN TO FLOOR TRAP WILL BE 63 OD UPVC WASTE PIPE.
- ALL WASTE FROM WASH BASIN TO F.T TRAP WILL BE 60 UPVC WASTE PIPE.
- ALL WASTE FROM URINALS TO F.T TRAP WILL BE 50 UPVC WASTE PIPE.
- ALL PIPES FROM F.T TO STACK WILL BE 110 OD UPVC PIPES OR OTHERWISE SPECIFIED.
- ALL PIPES FROM WC/UT TO STACK WILL BE 110 OD UPVC PIPES OR OTHERWISE SPECIFIED.

**PIPE DIAS**

S.NO.	SYMBOL	DESCRIPTION
1	WB TO FT	40 OD
2	URINAL TO UT	50 OD
3	FD TO FT	63 OD
4	FT/UT TO VERTICAL STACK	110 OD
5	WC TO VERTICAL STACK	110 OD

**TOTAL AREA IN SQ.M**

Area Type	Value
ADDITION AREA	3443.9844
SUBTRACTOR AREA	1078.011
<b>TOTAL AREA</b>	<b>2365.9734</b>